

ARCHITECT:

PROJECT:

**DOORMERICA**  
 ABS - Architectural Components  
 8401 Rovana Cir. Sacramento CA. 95828  
 Toll Free Number: (866) 566-2161  
 Phone Main: (916) 388-2161  
 Fax: (916) 388-9336

DISTRIBUTOR:

SHEET:

DATE:

3-3/4" WALL - 1-1/2" TRIM

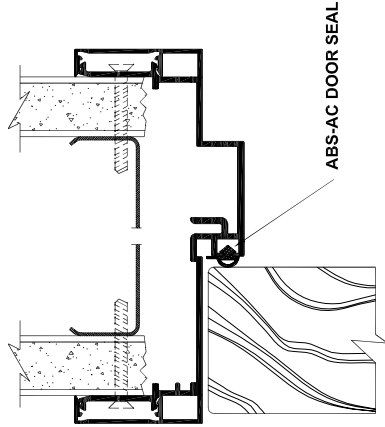

**A**

DOOR FRAME HEADER

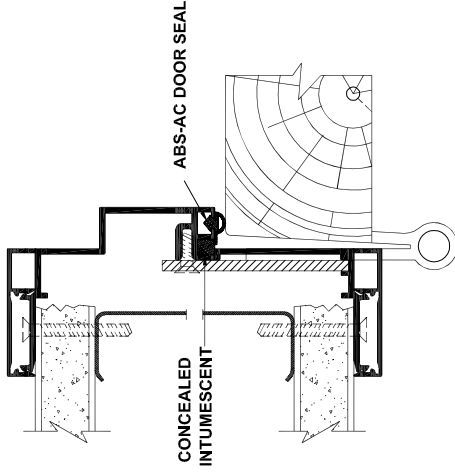

**B**

DOOR FRAME HINGE JAMB

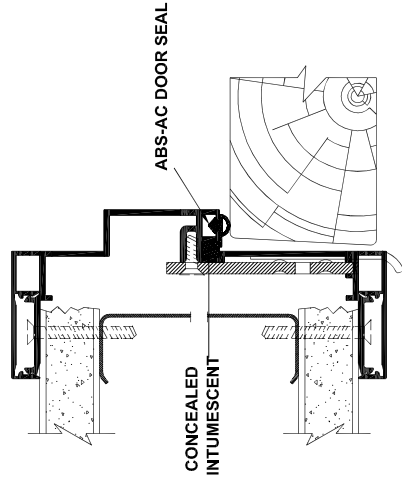

**C**

DOOR FRAME AT STRIKE JAMB  
NOTE: EXTENDED LIP STRIKE NOT REQUIRED

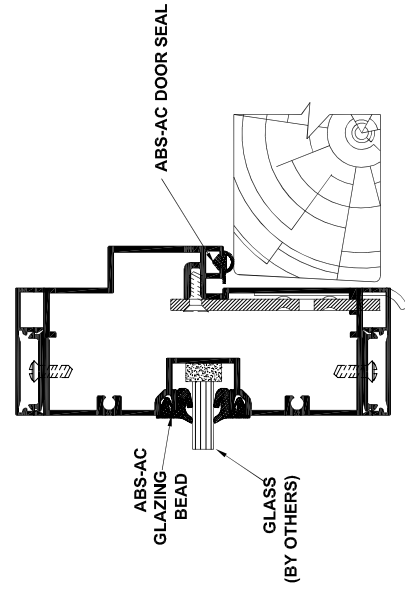

**D**

STRIKE JAMB & S.L. MULLION W/ 1-1/2" FACE  
NOTE: EXTENDED LIP STRIKE NOT REQUIRED

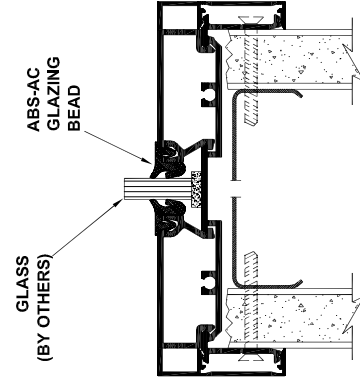

**E**

SILL BASE ON DRYWALL PARTITION

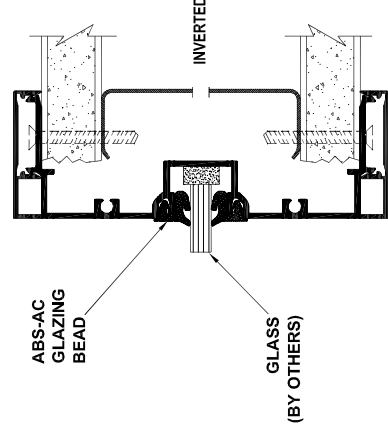

**F**

GLAZING RAIL

ARCHITECT:

PROJECT:

DISTRIBUTOR:

DATE:

SHEET:

**DOORMERICA**  
**ABS - Architectural Components**  
 8401 Rovana Cir. Sacramento CA, 95828  
 Toll Free Number: (866) 566-2161  
 Phone Main: (916) 388-2161  
 Fax: (916) 388-9336

3-3/4" WALL - 1-1/2" TRIM

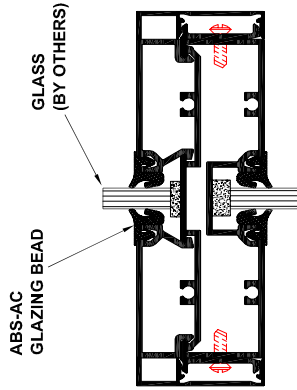

**G**

HORIZONTAL MULLION W/ 1-1/2" FACE

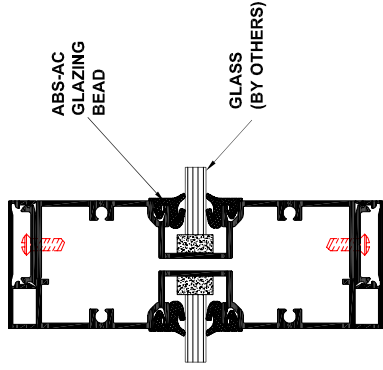

**H**

VERTICAL MULLION W/ 1-1/2" FACE

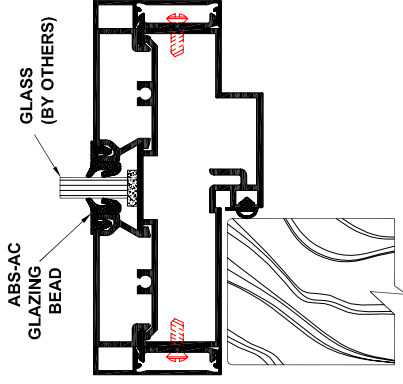

**I**

TRANSOM HEADER W/ 1-1/2" FACE

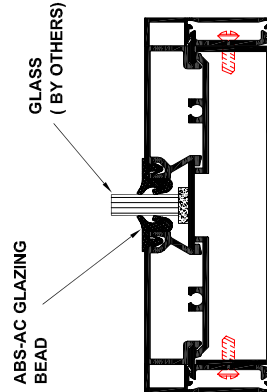

**J**

SILL BASE WITH RETAINER

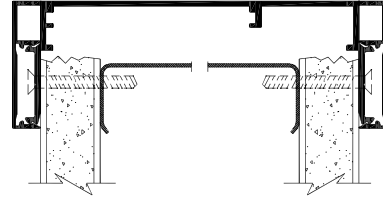

**K**

CASED OPENING