

ARCHITECT:

PROJECT:

DISTRIBUTOR:

DATE:

SHEET:

**DOORMERICA**  
 ABS - Architectural Components  
 8401 Rovana Cir, Sacramento CA, 95828  
 Toll Free Number: (866) 566-2161  
 Phone Main: (916) 388-2161  
 Fax: (916) 388-9336

4-7/8" WALL - 1" TRIM

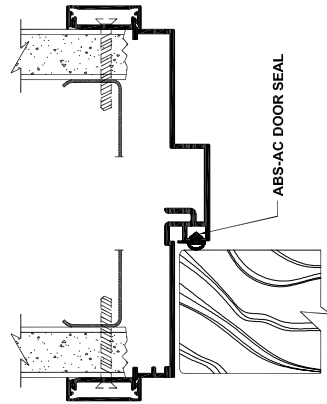

**A** DOOR FRAME HEADER

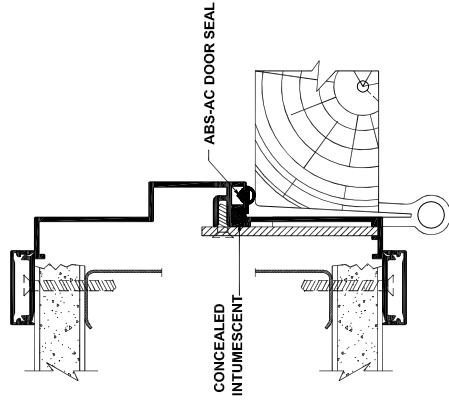

**B** DOOR FRAME HINGE JAMB

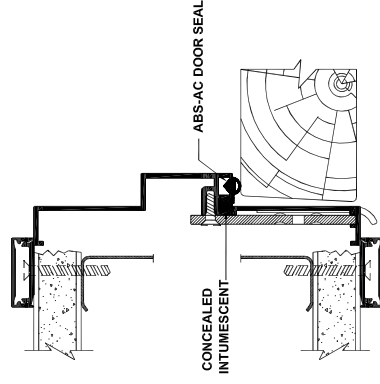

**C** DOOR FRAME STRIKE JAMB

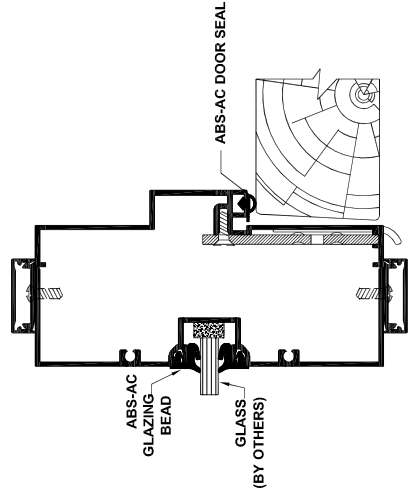

**D** STRIKE JAMB & S.L. MULLION W/ 2" FACE

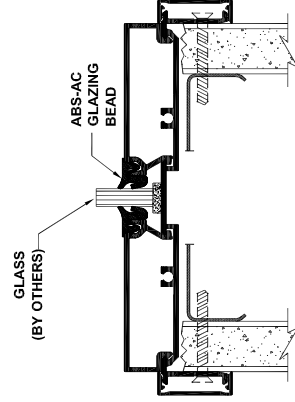

**E** SILL BASE ON DRYWALL PARTITION

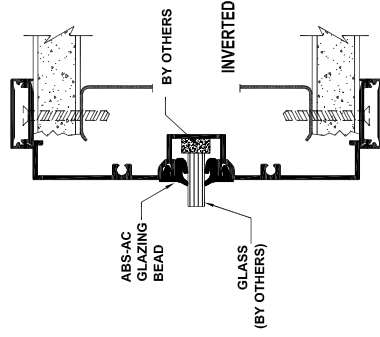

**F** GLAZING RAIL

ARCHITECT:

PROJECT:

DISTRIBUTOR:

DATE:

SHEET:

**DOORMERICA**

**ABS - Architectural Components**

8401 Rovana Cir. Sacramento CA, 95828  
Toll Free Number: (866) 566-2161  
Phone Main: (916) 388-2161  
Fax: (916) 388-9336

**4-7/8" WALL - 1" TRIM**

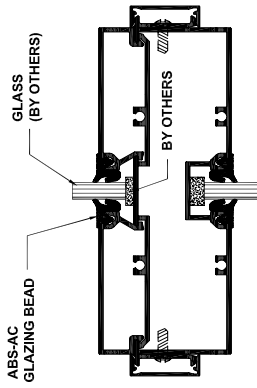

**G**

**HORIZONTAL MULLION W/ 2" FACE**

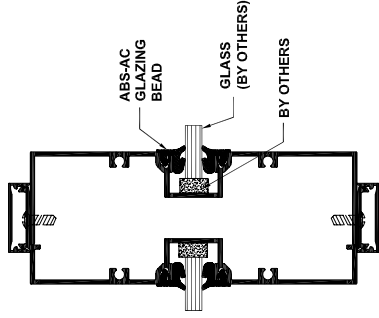

**H**

**VERTICAL MULLION W/ 2" FACE**

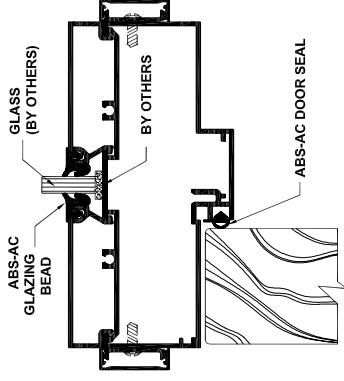

**I**

**TRANSOM HEADER W/ 2" FACE**

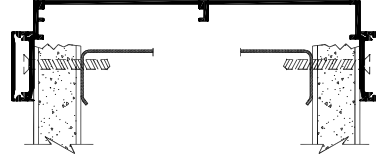

**K**

**CASED OPENING**

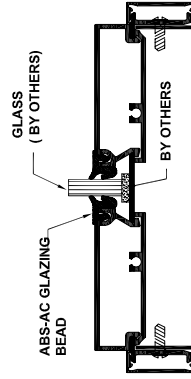

**J**

**SILL BASE AND SILL STOP W/ RETAINER**