

ARCHITECT:

PROJECT:

**DOORMERICA**  
 ABS - Architectural Components  
 8401 Rovana Cir. Sacramento CA. 95828  
 Toll Free Number: (866) 566-2161  
 Phone Main: (916) 388-2161  
 Fax: (916) 388-9336

DISTRIBUTOR:

DATE:

SHEET:

5-1/2" WALL - 1" TRIM

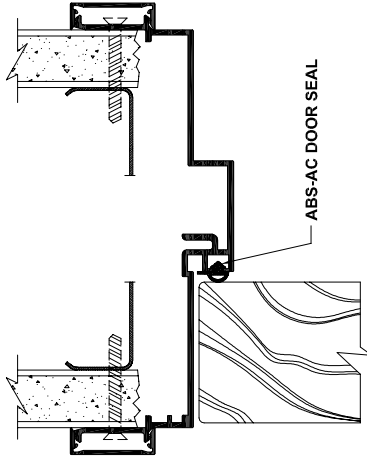

**A**

DOOR FRAME HEADER

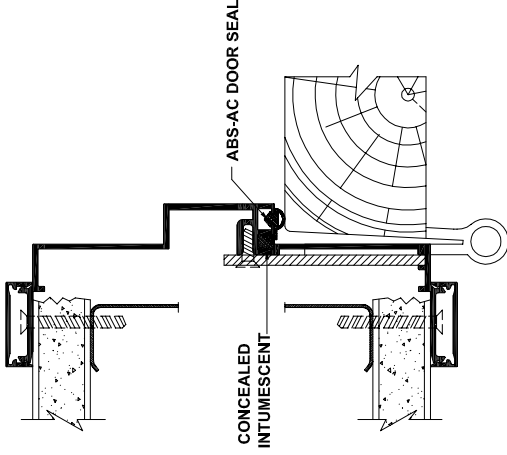

**B**

DOOR FRAME HINGE JAMB

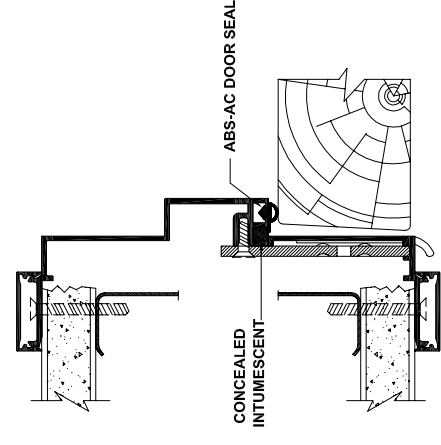

**C**

DOOR FRAME STRIKE JAMB

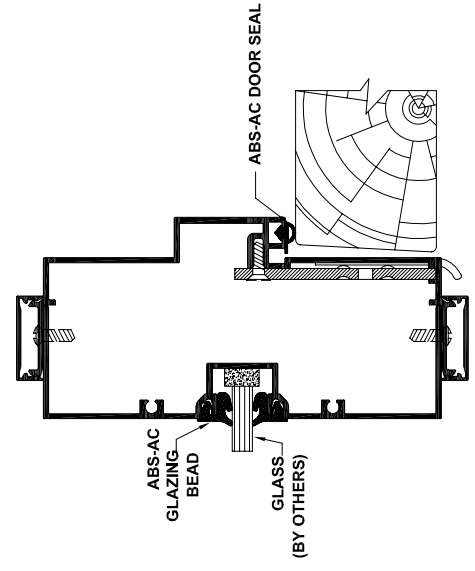

**D**

STRIKE JAMB & S.L. MULLION W/ 2" FACE

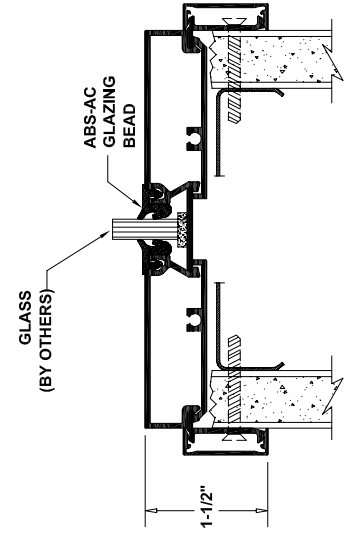

**E**

SILL BASE ON DRYWALL PARTITION

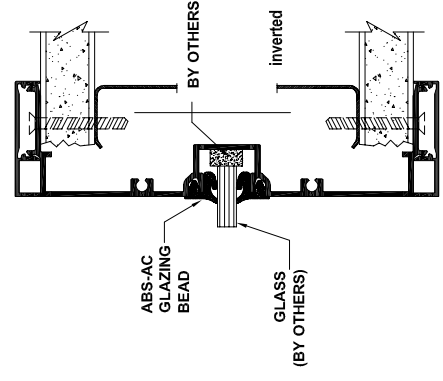

**F**

GLAZING RAIL

ARCHITECT:

PROJECT:

DISTRIBUTOR:

DATE:

SHEET:

**DOORMERICA**

ABS - Architectural Components

8401 Rovana Cir. Sacramento CA, 95828

Toll Free Number: (866) 566-2161

Phone Main: (916) 388-2161

Fax: (916) 388-9336

5-1/2" WALL - 1" TRIM

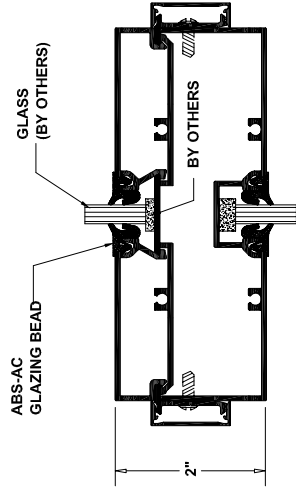

**G**

HORIZONTAL MULLION W/ 2" FACE

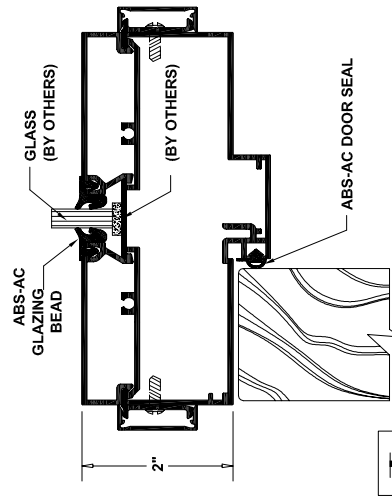

**I**

TRANSOM HEADER W/ 2" FACE

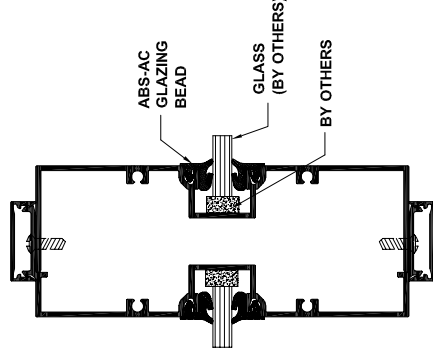

**H**

VERTICAL MULLION W/ 2" FACE

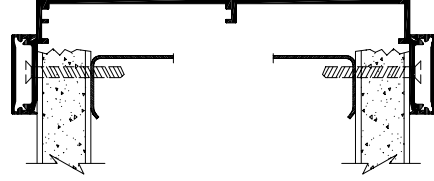

**K**

CASED OPENING

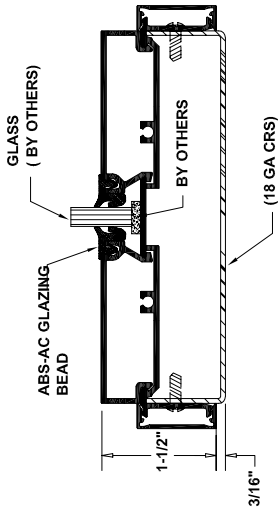

**J**

SILL BASE AND SILL STOP W/ RETAINER